

RDO COLLETS (ORTLEIB / OZ TYPE)

DIN 6388-FORM B

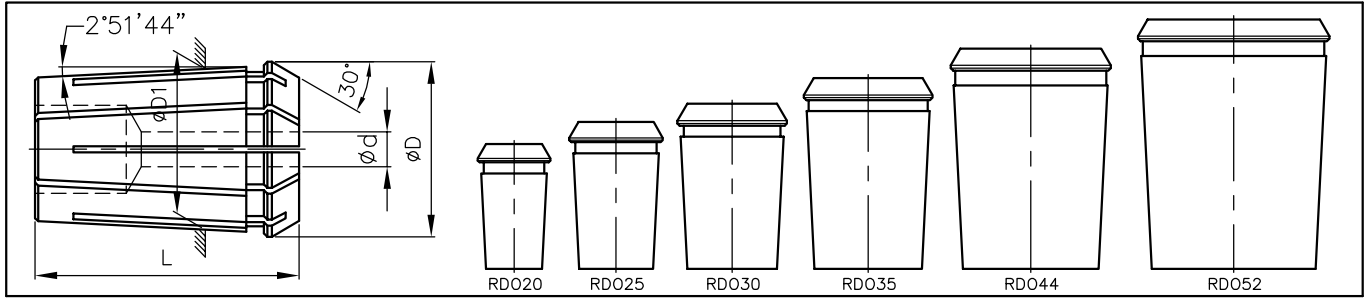

TYPE OF COLLET	ϕD	$\phi D1$	L	BORE DETAILS							COLLET		REFERENCE	NO OF PCS/SET	
				ϕd BORE RANGE				IN STEP OF		TYPE	COLLAPSES BY			MM	INCH
				MM		INCH		MM	INCH		MM	INCH			
				FROM	To	FROM	To			MM				INCH	MM
RD020	19.80	17.75	34.0	2.0	4.5	1/16	3/16	0.50	1/64	C/B *	0.50	1/64	OZ 407E	22	15
				5.0	12.0	1/16	1/2								
RD025	25.50	22.65	40.0	2.0	7.5	1/16	19/64	0.50	1/64	C/B	0.50	1/64	OZ 415E	29	19
				8.0	16.0	5/16	5/8								
RD030	29.80	27.40	45.0	2.0	8.5	1/16	11/32	0.50	1/64	C/B	0.50	1/64	OZ 4541E	37	24
				9.0	20.0	23/64	25/32								
RD035	35.05	32.90	52.0	2.0	9.5	1/16	3/8	0.50	1/64	C/B	0.50	1/64	OZ 462E	47	31
				10.0	25.0	25/64	1"								
RD044	43.70	41.30	60.0	4.0	11.5	1/8	29/64	0.50	1/64	C/B	0.50	1/64	OZ 467E	57	37
				12.0	32.0	15/32	1 1/4								
RD052	52.20	49.70	68.0	12.0	30.5	1/2	1 11/64	0.50	1/64	C/B	0.50	1/64	OZ 468E	57	35
				31.0	40.0	1 3/16	1 9/16								

Also available are:

1. Sealed collets for coolant through application (For details refer page no. 11)
2. Any other bore size on request at extra cost

* C/B = Counterbore, T/B = Throughbore

RUNOUT DETAILS:

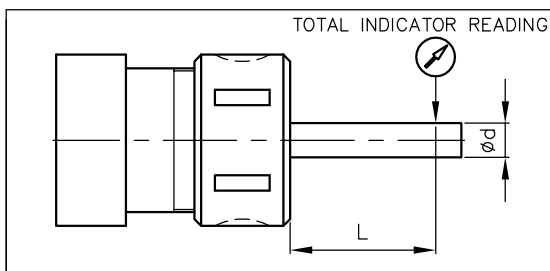

CLAMPING RANGE ϕd		L (mm)	RUNOUT (TIR)	
ABOVE	UPTO		PRECISION	HIGH PRECISION
2.0	3.0	10.0	0.015	0.010
3.0	6.0	16.0	0.015	0.010
6.0	10.0	25.0	0.015	0.010
10.0	18.0	40.0	0.015	0.015
18.0	24.0	50.0	0.020	0.015
24.0	30.0	60.0	0.020	0.015
30.0	50.0	80.0	0.030	0.020

Ordering Instruction:

RD035-1/4"-HP
 Collet Type Bore size Runout (TIR)